



## DATA SHEET

**residual current circuit-breaker**

**DFS 4 063-4/0,30-HP HD**

**AC-DC sensitive, fire protection according to VDE 0100-420, for heat pumps, for harsh environments**

**Article number 09146805HD**



### Function

Residual current circuit-breakers (RCCBs) are components for implementing protective measure "Automatic disconnection of the power supply" as per VDE 0100 part 410 or corresponding international installation regulations. Devices in the DFS 4 series are compact four-pole residual current circuit-breakers for single-phase or three-phase networks. In the standard version, they only occupy four division units. The AC/DC-sensitive switches detect smooth DC residual currents and all other residual currents in accordance with DIN VDE 0664-400. Switches of the HP (Heat Pump) series have been specially developed for the protection of heat pumps. The protection level of the AC/DC sensitive residual current circuit breaker meets all requirements of heat pump manufacturers. In addition, the HP-optimised short-time delay ensures increased system availability. With an airtight, encapsulated tripping mechanism from a special alloy and the stainless steel latch, residual current circuit-breakers in HD design are protected, in particular from corrosion, corrosive gases, moisture and extreme temperature fluctuations.

### Features

AC/DC sensitive for residual currents with frequencies and mixed frequencies from 0 Hz to 20 kHz, fire protection according to VDE 0100-420, complete functionality with mains voltages from at least 50 V AC on any two active conductors, high short-circuit resistance, double-sided double-decker terminals for large conductor cross-section and busbar connection, switching position indicator, multifunction control toggle with three positions: "on", "off", "triggered", any neutral conductor position

### Mounting

quick fastening to mounting rail, any installation position, supply preferably from above

### Applications

RCCBs of the HP series are suitable for commercial and industrial installations with TN-S, TT and TN-C-S systems in which heat pumps come into use.

### Notes

suitable for use in 50 Hz AC networks, not intended for use on the output side of controlled electrical equipment such as frequency converters

### Accessories

automatic reclosing devices DFA, terminal caps KA, information stickers HAS, auxiliary switches DHi, restart locks DFS WES, software DBS

### Technical Data

Technical Data	DFS 4 063-4/0,30-HP HD
Series	DFS 4 HP HD
Number of poles	4
Residual current type	B+
Rated current (AC)	63 A
Rated residual current I $\Delta$ n	0.3 A
Short-time delayed	true
Selective	false
min. Operating voltage range of test circuit	200 V

Subject to technical changes



Technical Data	DFS 4 063-4/0,30-HP HD
Ambient temperature	-25 °C ... 60 °C
Climate resistance	according to IEC 60068-2-30: humid heat / cyclic (25 °C / 55 °C; 93 % / 97 % RH)
Housing type	distribution board housing
Installation type	Mounting rail (35 mm)
Housing material	thermoplastic
Protection class	IP20 (installed: IP40)
sealable	true
Width	72 mm
Height	85 mm
Depth	75 mm
Installation depth	69 mm
Module widths	4
Design requirements/Standards	VDE 0664-10, VDE 0664-400, ÖVE/ÖNORM E 8601
Degree of pollution	2
Certifications	VDE

**Dimensions**

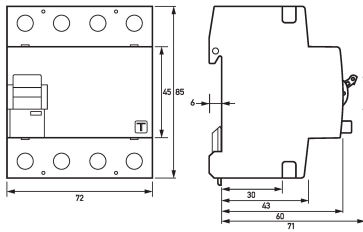

Dimensional drawing Group view

**Wiring example**

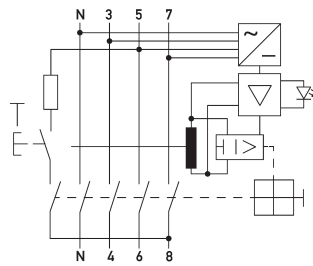

Wiring diagram