



## DATA SHEET

### residual current circuit-breaker

#### DFS 4 063-4/0,03-HP HD

AC-DC sensitive, fire protection according to VDE 0100-420, for heat pumps, for harsh environments

Article number 09144805HD

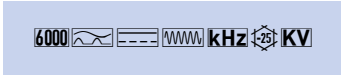

#### Function

Residual current circuit-breakers (RCCBs) are components for implementing protective measure "Automatic disconnection of the power supply" as per VDE 0100 part 410 or corresponding international installation regulations. Devices in the DFS 4 series are compact four-pole residual current circuit-breakers for single-phase or three-phase networks. In the standard version, they only occupy four division units. The AC/DC-sensitive switches detect smooth DC residual currents and all other residual currents in accordance with DIN VDE 0664-400. Switches of the HP (Heat Pump) series have been specially developed for the protection of heat pumps. The protection level of the AC/DC sensitive residual current circuit breaker meets all requirements of heat pump manufacturers. In addition, the HP-optimised short-time delay ensures increased system availability. With an airtight, encapsulated tripping mechanism from a special alloy and the stainless steel latch, residual current circuit-breakers in HD design are protected, in particular from corrosion, corrosive gases, moisture and extreme temperature fluctuations.

#### Features

AC/DC sensitive for residual currents with frequencies and mixed frequencies from 0 Hz to 20 kHz, fire protection according to VDE 0100-420, complete functionality with mains voltages from at least 50 V AC on any two active conductors, high short-circuit resistance, double-sided double-decker terminals for large conductor cross-section and busbar connection, switching position indicator, multifunction control toggle with three positions: "on", "off", "triggered", any neutral conductor position

#### Mounting

quick fastening to mounting rail, any installation position, supply preferably from above

#### Applications

RCCBs of the HP series are suitable for commercial and industrial installations with TN-S, TT and TN-C-S systems in which heat pumps come into use.

#### Notes

suitable for use in 50 Hz AC networks, not intended for use on the output side of controlled electrical equipment such as frequency converters

#### Accessories

automatic reclosing devices DFA, terminal caps KA, information stickers HAS, auxiliary switches DHi, restart locks DFS WES, software DBS

#### Technical Data

Technical Data	DFS 4 063-4/0,03-HP HD
Series	DFS 4 HP HD
Number of poles	4
Residual current type	B+
Rated current (AC)	63 A
Rated residual current I $\Delta$ n	0.03 A
Short-time delayed	true
Selective	false
min. Operating voltage range of test circuit	250 V

Subject to technical changes

Technical Data	DFS 4 063-4/0,03-HP HD
max. Operating voltage range of test circuit	440 V
Minimum rated operating voltage (Type A/AC operation)	0 V AC
Minimum rated operating voltage (Type B operation)	50 V AC
Non-trip time	13 ms
Tripping frequency	0 Hz ... 20 kHz
Maximum disconnection times	$1 \cdot I_{\Delta n} \leq 300 \text{ ms}$ ; $5 \cdot I_{\Delta n} \leq 40 \text{ ms}$
Internal consumption	max. 1.3 W
<b>load circuit</b>	
Specification	load disconnect contact
min. Contact opening	4 mm
Rated voltage (AC)	230 V, 400 V
Rated current (AC)	63 A
Rated short-circuit current	6 kA
Surge current strength	3 kA
max. total rated switching capacity	630 A
Rated insulation voltage	400 V
Rated impulse withstand voltage	4 kV
Rated frequency	50 Hz
Current heat loss per current path	3.1 W
thermal Backup-fuse OCPD	63 A
short-circuit backup-fuse SCPD	100 A
Back-up fuse type	gG
<b>screw-type terminal top and bottom (load circuit)</b>	
Neutral conductor position	left
Protection against direct contact	DGUV V3, VDE 0660-514, finger and back-of-hand proof
Connection C1 Maximum number of conductors per terminal	2 (conductors of same type and cross-section)
Cross section solid	1-wire: 1.5 mm <sup>2</sup> ... 50 mm <sup>2</sup> ; 2-wire: 1.5 mm <sup>2</sup> ... 16 mm <sup>2</sup>
Connecting capacity flexible	1-wire: 1.5 mm <sup>2</sup> ... 50 mm <sup>2</sup> ; 2-wire: 1.5 mm <sup>2</sup> ... 16 mm <sup>2</sup>
Cross section stranded	1-wire: 1.5 mm <sup>2</sup> ... 50 mm <sup>2</sup> ; 2-wire: 1.5 mm <sup>2</sup> ... 16 mm <sup>2</sup>
Cross section AWG, solid	15 ... 1
Cross section AWG, stranded	15 ... 1
Cross section AWG, flexible	15 ... 1
Cross section AWG, flexible with ferrule	15 ... 1
Tightening torque	2.5 Nm ... 3 Nm
<b>General data</b>	
Operating position	optional
max. Operating altitude above MSL	2000 m
Mechanical endurance	min. 4000 cycles
Electrical endurance	min. 2000 cycles
Surrounding atmosphere	harsh environmental conditions
Storage temperature	-35 °C ... 75 °C

Subject to technical changes

Technical Data	DFS 4 063-4/0,03-HP HD
Ambient temperature	-25 °C ... 60 °C
Climate resistance	according to IEC 60068-2-30: humid heat / cyclic (25 °C / 55 °C; 93 % / 97 % RH)
Housing type	distribution board housing
Installation type	Mounting rail (35 mm)
Housing material	thermoplastic
Protection class	IP20 (installed: IP40)
sealable	true
Width	72 mm
Height	85 mm
Depth	75 mm
Installation depth	69 mm
Module widths	4
Design requirements/Standards	VDE 0664-10, VDE 0664-400, ÖVE/ÖNORM E 8601
Degree of pollution	2

**Dimensions**

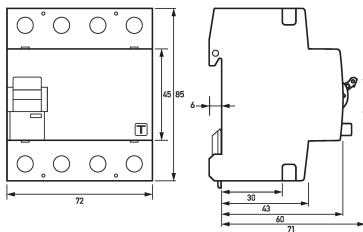

Dimensional drawing Group view

**Wiring example**

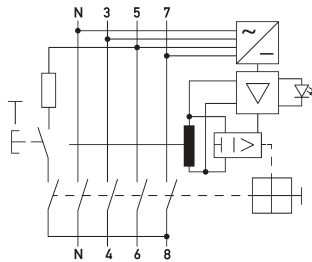

Wiring diagram