

INSTALLATION IN GYPSUM BOARDS, THIN STEEL AND OTHER THIN MATERIALS:

1. Drill a 6mm hole through the material
2. Insert the wire with the Toggle-fastener in the hole

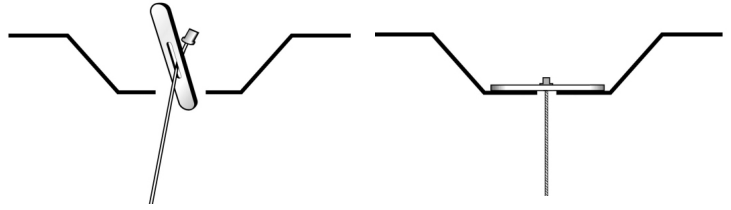

INSTALLATION IN CONCRETE:

1. Drill a 6mm hole - Min. 30mm deep in the concrete
2. Make a loop through the Toggle-fastener
3. Fix the Concrete Fastener in the loop
4. Hit in the Concrete Fastener into the hole min 30 mm

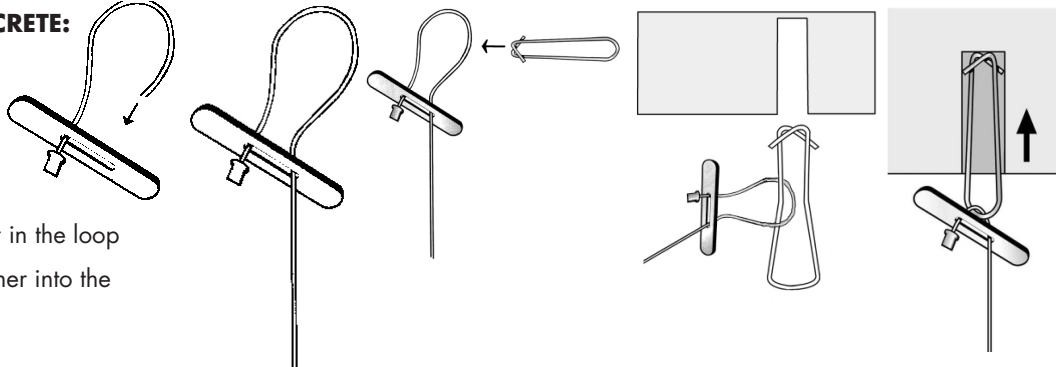

ASSEMBLY AND ADJUSTMENT OF GRIPPLE:

1. First assemble the wire in the Express lock's round hole - can be mounted from both sides
2. Pull up the lock to the appropriate position on the wire
3. Pass the wire through the component to be installed, insert the wire in the round hole from below in Gripple Express
4. Adjust upwards by pulling the entire lock up on the wire or by holding the lock and pulling the wire end
5. The downward adjustment or dismantling of the installation, use the release button and release teeth so that the wire can move freely
6. When dismantling the installation or if the adjustment button don't release the Gripple Express, pull the wire upwards and try again and it will release

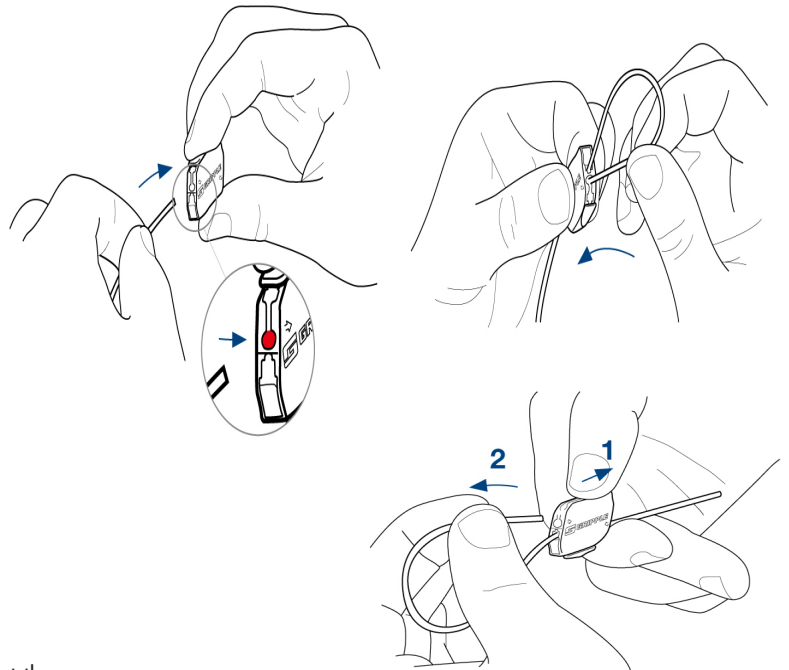

RECOMMENDED LOADS:

Always check that the roofing material can withstand at least the recommended load

Gripple Express No.1, 1 - 15 kg

When installing the Gripple Express at an angle the maximum loads are reduced as shown below.

Max load mounting Gripple Express No.1 at an angle:
 0° = 15kg • 15° = 14kg • 30° = 13kg • 45° = 12kg • 60° = 11kg

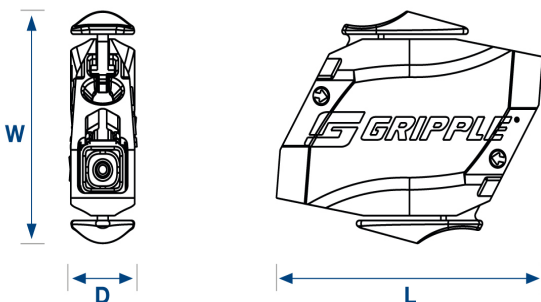

Gripple express No.1 - lock with adjustment buttons

WHAT TO CONSIDER WHEN INSTALLING GRIPPLE:

- Add about 0.5 m length to use when selecting the wire-length
- Always use the recommended loads. (Gripple No1: 15kg)
- Always use Gripple within the recommended load-groups
- Always distribute the load evenly between several Gripple
- Always check that the roofing material can withstand at least use the load
- Check that the wire hangs in the wire lock
- Extend never a wire with wire-lock
- Never use a painted, plastic coated wire
- Always use the supplied wire
- Do not use lubricants
- Cut off any damaged wire ends before mounting
- In corrosive environments, use our stainless steel models

COVER CAP ACCESSORY

INSTALLATION IN GYPSUM BOARDS, THIN STEEL AND OTHER

THIN MATERIALS:

1. Drill a 6mm hole through the material
2. Insert the wire with the Toggle-fastener in the hole

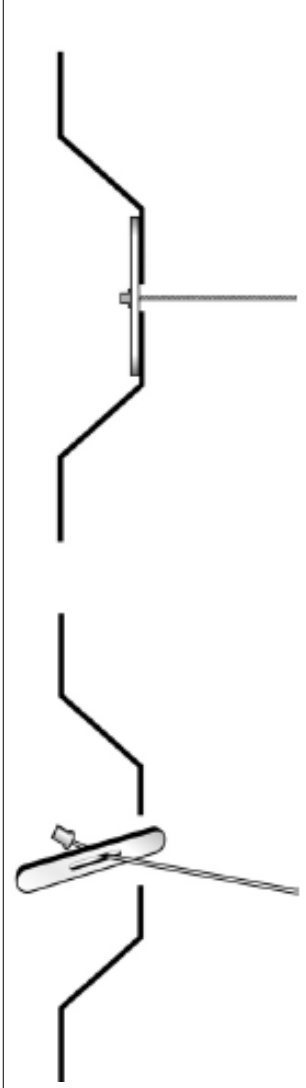

COVER CAP ACCESSORY

Put the cover cap on the wire

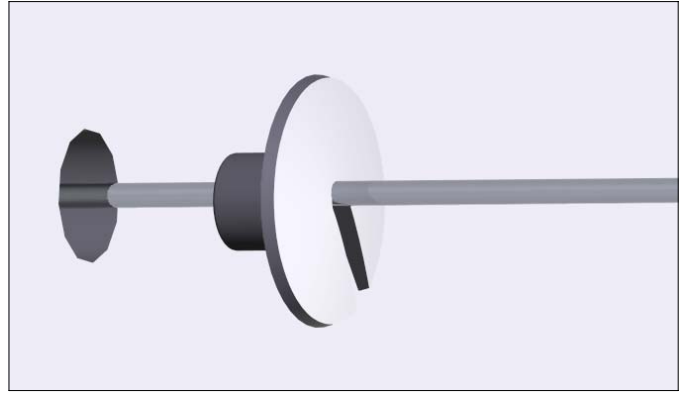

Push it up towards the ceiling

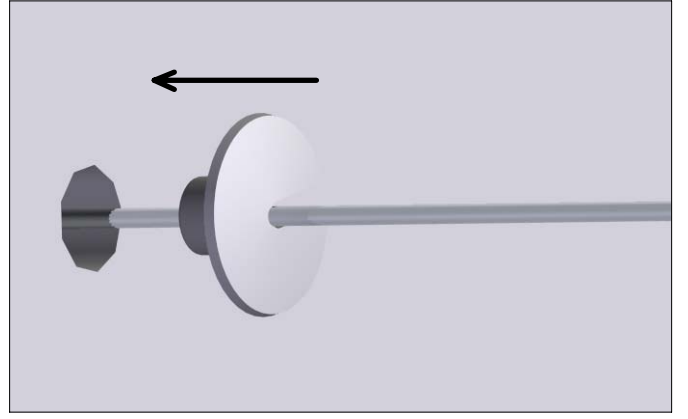

The mounting of the cover cap is done

