



Configured Teleblock telescopic profile with manual elevation aluminium Simon K45

Ref.: **KTL212**

BASIC INFORMATION

| | |
|------------------------------------|--|
| Version | 2 elements |
| Number of modules | 2 modules |
| Type of elevation | Manual |
| Space for cabling distribution | The profile is supplied with 1 blind plate and two 22.5 x 45 mm plates, for a more effective internal distribution of cabling. |
| Cabling access | Through the space enabled in the lower part of the profile. |
| Cabling access typology | Supplied with combined access plate for electricity, voice and data cabling |
| Linkable | No |
| Monoblock | No |
| Intensity | 16 A |
| Voltage | 250 V~ |
| Number of sockets | 2 sockets for standard current circuits |
| Format | Toma de tierra Schuko |
| Type of terminal connection | Fast |
| Number of terminals | 3 inputs / 3 outputs |
| Number of connections per terminal | 2 connections per terminal |
| Type of mechanism | Insertion |
| Indicator function | No |
| Finish | Graphite |
| Available in | Available configured for 2 and 5 elements and available to configure for 2, |

| | |
|---|--|
| | 3, 4, 5 and 6 elements |
| Expandable | No |
| Kit configuration | 2 electrical sockets for standard current and 1 3x2.5 mm patch cord 2 metres long with a Schuko plug. |
| Number of cover opening positions | Sí |
| Possibility of including quick-connect connectors along the side of the housing | No |
| Protection against entry of dust and small objects | Yes, thanks to the silicone gasket on the cover that prevents the entry of external elements when there are no connections. Yes, thanks to the silicone gasket on the cover that prevents the entry of external elements when there are no connections. |
| Packaging contents | Telescopic profile with manual elevation, 2 graphite sockets, 1 2-metre long electrical patch cord with a Schuko plug, non-slip joints, metal separator, 2 ground connections, 3 blind plates (1 wide and 2 narrow), fastening thread and installation manual. |
| Remarks | To complete the installation of the product it must be combined with the cover and trim frame (refs. KTLA1/14 or KTLA1/31). |

Technical information

| | |
|---|---|
| Dimensions | 103 x 60 mm |
| Depth | 242 mm |
| Height of profile in extended position | 89 mm |
| Height of profile in concealed position | 3 mm |
| Elevation of frame from ground level | 3 mm |
| Personalisation of flush-mount cover dimensions | Ø104 mm |
| Cable section admitted | 1.5 to 2.5 mm |
| Cable stripping necessary | 12 mm |
| Heat resistance | +70°C (according to standard IEC 60670) |
| Extinguishing | +850°C (according to standard IEC 60670) |
| Insulation resistance | >5 MOhm at 500 V |
| Dielectric strength | Without perforation or contournement with 2000 V at 50Hz during 1 minute |
| Number of lower entrances | 1 inlet, with the possibility for 6-cable access through the lower part of the profile via the K20/14 plate. The profile is supplied with the modular lower part to allow access of a variable quantity and type of cabling. |
| Electromagnetic immunity for VDM wiring | Ensured by the fixing of the metal separator in the rail enabled in the bracket for this purpose. |
| IP rating | 4X |
| RAL | 7021 |
| Manufacturing material | Anodised aluminium profile with fastening bracket and top and bottom closure in self-extinguishing halogen-free thermoplastic that guarantees no flame spread in case of fire, and low toxicity in the event of smoke generation. |
| Type of product | Standard |
| Market available | CE |

Regulations

Regulations

Directive 2014/35/UE LVD + Directive 2011/65/UE
RoHS + EN 50581:2012 + EN 60670-1:2005 + IEC
60884-1 Ed 3.2

Installation and maintenance

Installation type

Suitable for embedding in furniture.

Securing possibilities

Its design allows its integration into any type of furniture, combining the telescopic profile with the cover and trim frame (ref. KTLA1/14, graphite finish, and ref. KTLA1/31, matt chrome finish)

Type of fastening

By tightening the fastening thread supplied with the Simon K45 Teleblock telescopic profile.

Securing without accessories

The telescopic profile is supplied with all the material necessary for installation, including the fastening bracket, with no need to employ additional articles for fastening.

Installation direction

Vertical (it can also be installed horizontally).

Opening orientation

Top and bottom.

Removal of the socket

Only with tool

Removal of cover

Only with tool

Removal of the plate

Only with tool

Removal of components

Only with tool

Recess dimension

Ø114 mm

Temperature range during installation

-5 to 60° C

Max. temp. during construction work

+60° C

Maintenance

Clean with a soft dry cloth. Do not use tissues and/or abrasive cleaners containing chlorine.

Instalación Installation Installação

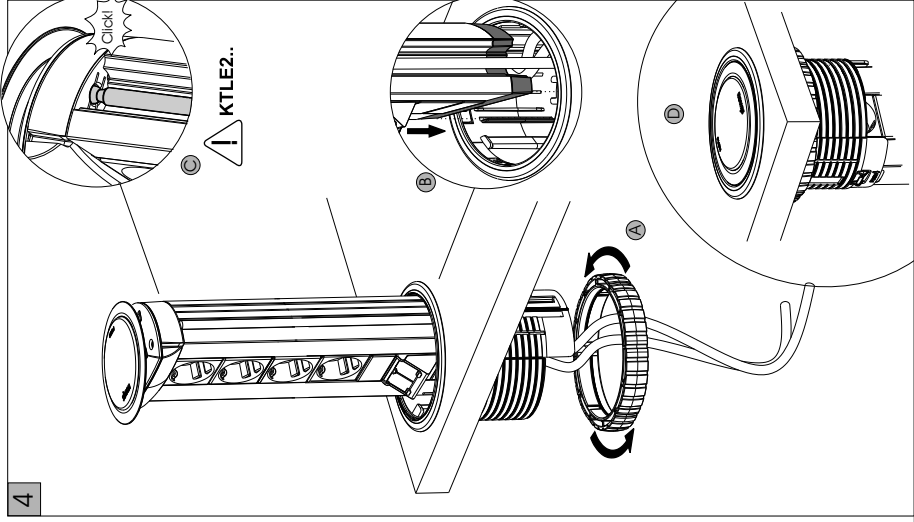
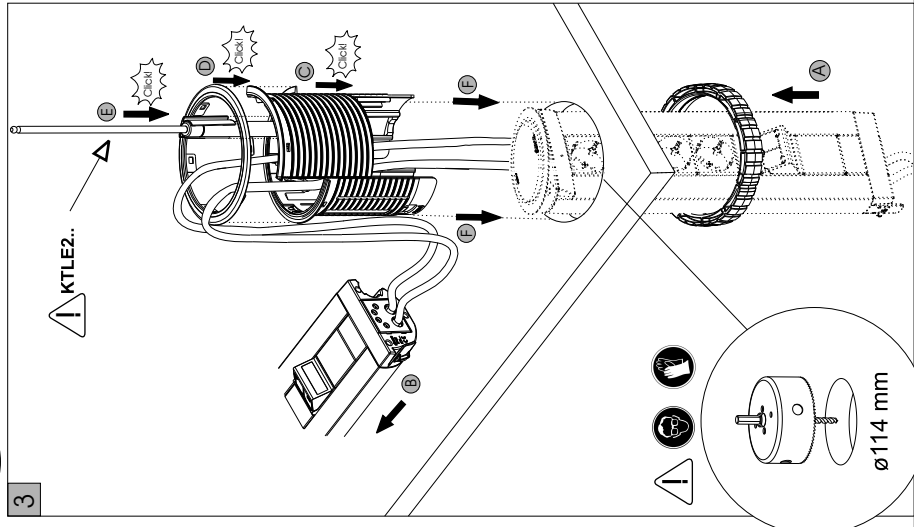
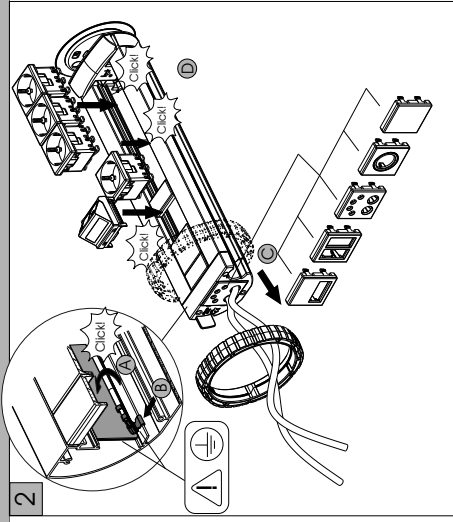
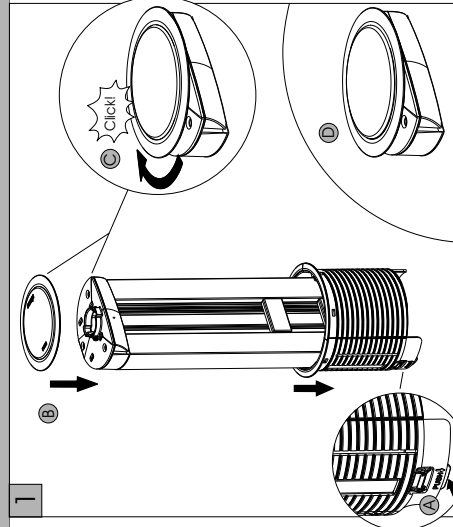

Funcionamiento Functioning

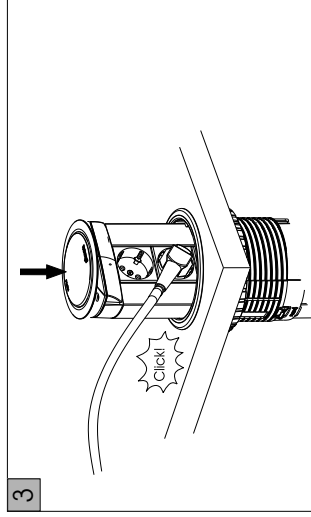
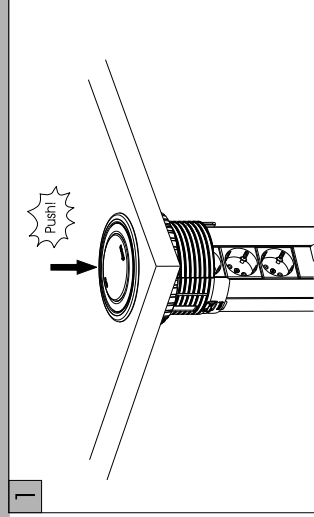

Functionnement Fonctionnement

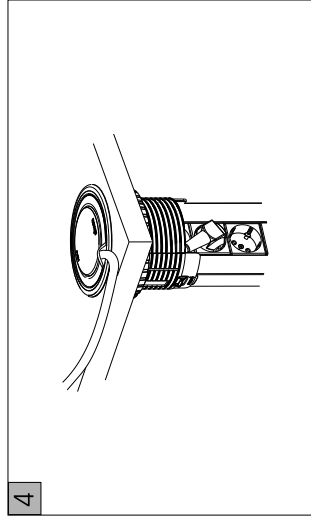
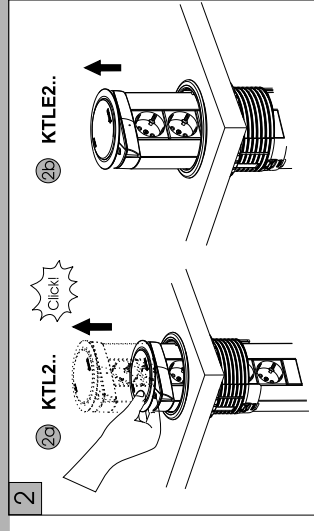

Desinstalación Uninstal Désinstallation Desinstalação

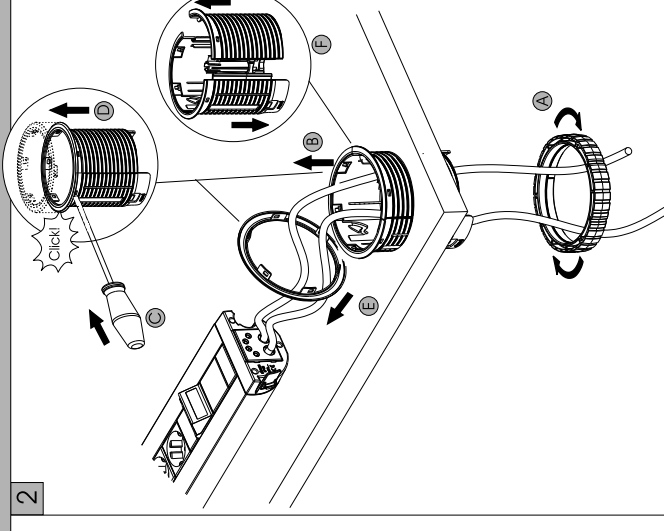
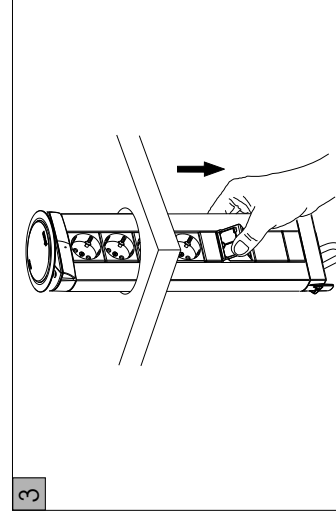
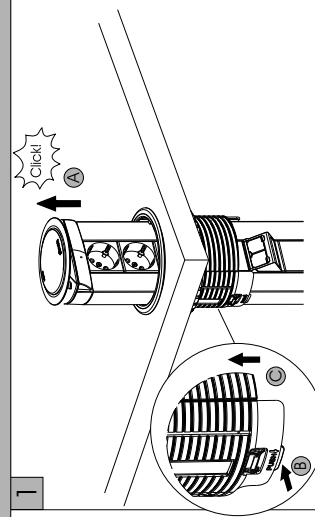

DECLARACIÓN UE DE CONFORMIDAD (UES0062) UE DECLARATION OF CONFORMITY

Los productos detallados a continuación:
The products following detailed:

| REFERENCIA <i>Reference</i> | DESCRIPCIÓN PRODUCTO | PRODUCT DESCRIPTION |
|--------------------------------|--|--|
| KTL20a | TELEBLOCK MANUAL a ELEMENTOS 45X45MM | MANUAL TELEBLOCK a 45X45MM K45 ELEMENTS |
| KTLA1/bb | TAPA Y MARCO EMBELLECEDOR TELEBLOCK | COVER AND TRIM FRAME FOR TELEBLOCK |
| KTLE205 | TELEBLOCK AUTOMÁTICO 5 ELEMENTOS 45X45MM | AUTOMATIC TELEBLOCK 5 45X45MM K45 ELEM. |
| KTL212 | TELEBLOCK MANUAL+2 BASES SCHUKO Y CABLE | MANUAL TELEBLOCK+2 SCHUKO SOCKETS+CABLE |
| KTL216U | TELEBLOCK MANUAL+4 SCHUKO+2 RJ45 C.6 UTP | MANUAL TELEBLOCK+4 SCHUKO+2 RJ45 C.6 UTP |
| KTLA2 | CILINDRO GAS TELEBLOCK ELEV. AUTOMÁTICA | GAS CYLINDER TELEBLOCK W/AUTOMATIC ELEV. |
| KTLA3 | MÓDULO PUSH-PULL TELEBLOCK ELEV. MANUAL | PUSH-PULL MODULE TELEBLOCK MANUAL ELEV. |
| KTLA4 | SOPORTE FIJACIÓN TELEBLOCK ELEV. MANUAL | FASTENING BRACKET TELEBLOCK MANUAL ELEV. |
| KTLA5 | CIERRE SUPERIOR TELEBLOCK ELEV. MANUAL | UPPER CLOSURE TELEBLOCK W/MANUAL ELEV. |
| KTLA6 | CIERRE INFERIOR TELEBLOCK ELEV. MANUAL | LOWER CLOSURE TELEBLOCK W/MANUAL ELEV. |
| KTLA7 | SOPORTE FIJACIÓN TELEBLOCK ELEV.AUTOMÁT. | FASTENING BRACKET TELEBLOCK AUTOM. ELEV. |
| KTLE216U | TELEBLOCK AUTOMÁTICO+4 SCHUKO+2RJ 6 UTP | AUTOMATIC TELEBLOCK+4 SCHUKO+2RJ C.6 UTP |
| TS10/14 | SALIDA DE CABLES MESA/SUELO TÉCNICO | CABLE OUTLET TABLE/RAISED FLOOR |
| TS10/8 | SALIDA DE CABLES MESA/SUELO TÉCNICO | CABLE OUTLET TABLE/RAISED FLOOR |
| K66 | POSICIONADOR 90° PLACAS V&D POS.VERTICAL | 90° POSITIONER V&D PLATES VERTICAL ENCL. |

Donde: a: 2,3,4,5,6
Where: bb: 14, 31

Fabricados por la empresa:
Manufactured by the company:

SIMON, S.A.U.

Instalados de acuerdo con las Normas de instalación, instrucciones del fabricante y conforme a las reglas profesionales, debidamente mantenidos y utilizados en las aplicaciones para las que están previstos, son conformes con la legislación de armonización de la unión:

Installed in concordance to the installation standards, manufacturer's instructions and professional rules, duly maintained and used for the applications as intended, are in conformity with the Union harmonisation legislation:

Directive 2014/35/UE LVD
Directive 2011/65/UE RoHS

y son conformes con las siguientes normas:
and it is in conformity with the following standards:

EN 60670-1:2005
EN 50581:2012
IEC 60884-1 Ed. 3.2^{*1}
EN 50173-1:2011^{*2}
IEC 60603-7-4:2010^{*2}

***1 sólo para referencias con bases**

**1 only for references with sockets*

***2 sólo para referencias con RJ45 + Conector Cat 6 UTP**

**2 only for references with RJ45 + Cat 6 UTP Connector*

Información adicional:
Additional information:

Este producto está previsto para ser instalado y mantenido por un profesional, puede ser usado por una persona no formada para reemplazamiento de uno idéntico.

This product is intended to be installed and maintained by skilled people, it may be used by ordinary people only as a replacement part, to substitute for an identical device.

Nombre, cargo y firma de la persona autorizada
Name, function and signature of the authorized person

JORGE LUIS DAPENA DOMINGUEZ
Director I+D

Barcelona, 14 de julio de 2017



www.simonelectric.com



SIMON, S.A.U.

Diputación, 390-392
08013 Barcelona (Spain)
Tel.: +34 93 547 81 81