

FUTURA TECH NB IP66 IK10 t_a 40 °C

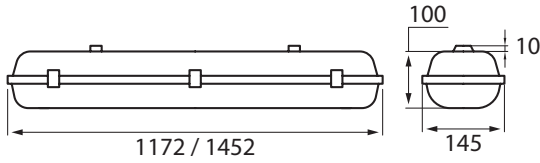

TEOLLISUUSVALAISIN SULJETTU | KAPSLAD INDUSTRIARMATUR | SEALED INDUSTRIAL LUMINAIRE



	A [mm]	D [mm]
2.2ft	612	475
2.4ft	1172	700
2.5ft	1452	940

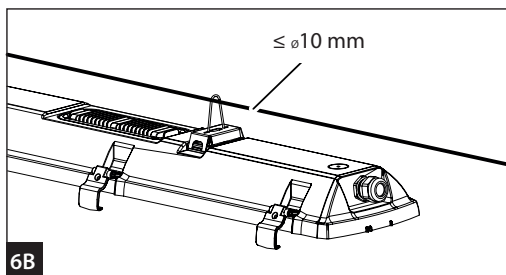
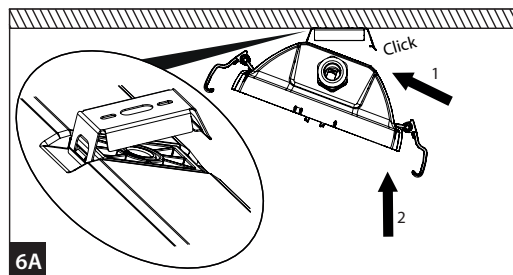
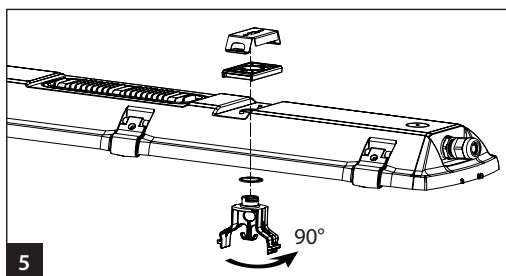
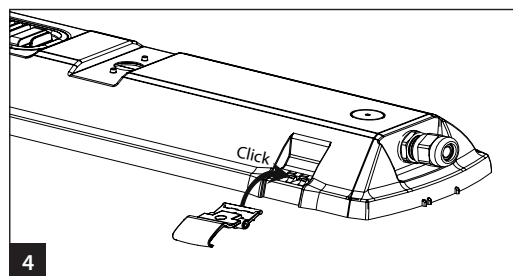
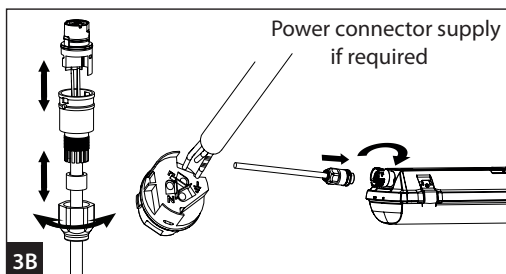
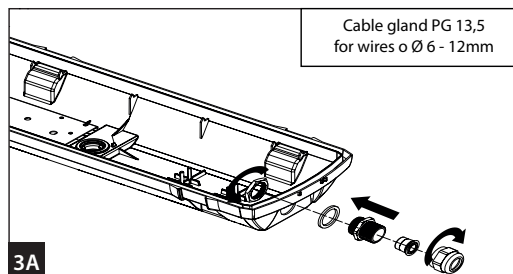
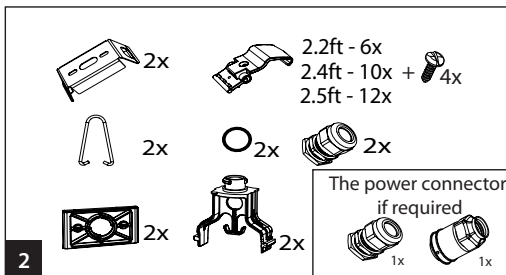
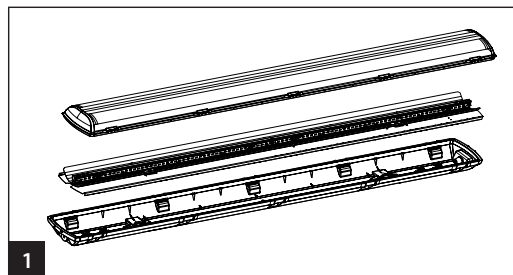
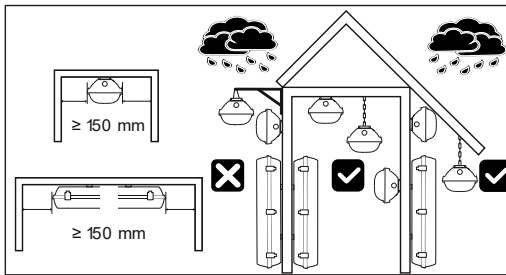

Valaisimen saa asentaa vain sähköalan ammattilainen. Käytä ainoastaan syöttöjännitettä ja taajuutta joka on merkitty valaisimeen/liitäntälaitteeseen. Kytke virta pois päältä ennen asennusta tai huoltoa. Tämä asennusohje on säilytettävä ja sen on oltava käytössä asennuksessa ja huollossa. Tämän valaisimen valonlähde ei ole vaihdettavissa. Kun valonlähde rikkoutuu, koko valaisin on poistettava käytöstä.

Vi rekommenderar att installationen görs av en behörig elektriker. Använd endast driftspänning och frekvens som är märkt på armaturen/förkopplingsdonet. Bryt stömmen före installation eller service. Denna monteringsanvisning bör sparas och finnas tillgänglig vid installation eller framtida service. Ljuskällan till denna armatur kan inte bytas ut. När ljuskällan når sin livslängd ska hela armaturen bytas ut.

Only a professional electrician is allowed to do the installation. Use only rated voltage and frequency as marked in the fixture/driver. Switch off the current before installation or service. This mounting instruction must be kept available during installation and for future maintenance. The light source of this luminaire is not replaceable; when the light source reaches its end of life the whole luminaire shall be replaced.

FUTURA TECH NB IP66 IK10 t_a 40 °C ∇ -O- 5 x 2,5 DALI

TEOLLISUUSVALAISIN SULJETTU | KAPSLAD INDUSTRIARMATUR | SEALED INDUSTRIAL LUMINAIRE

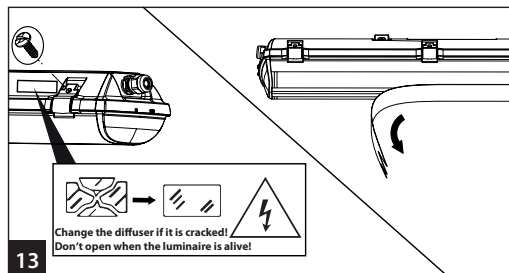
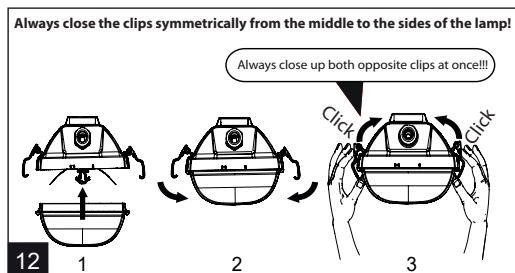
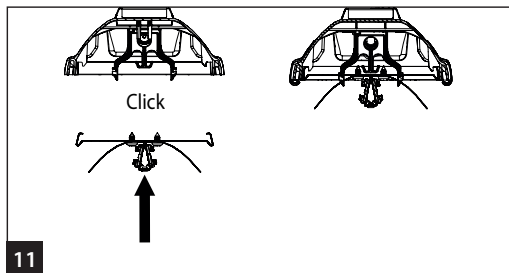
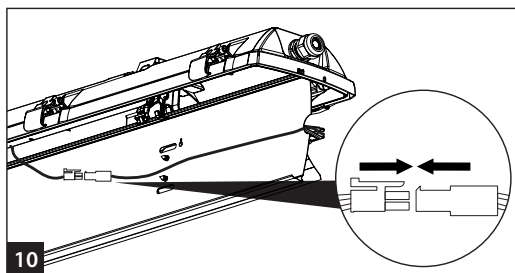
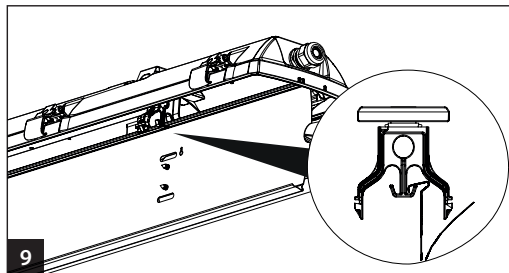
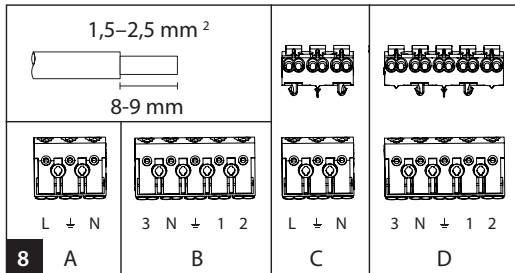
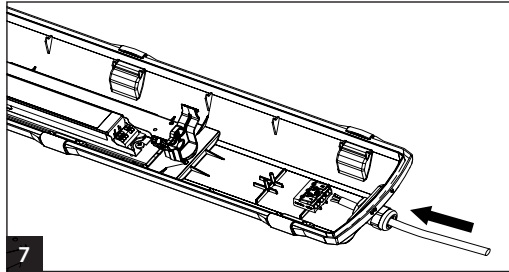
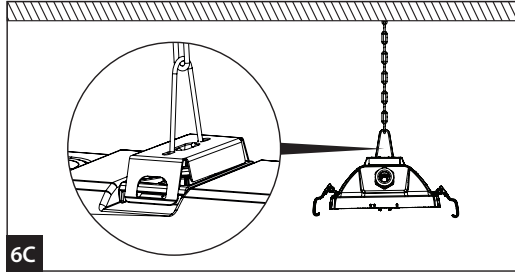

Table of maximal number of luminaires in one line				10A B	16A B	10A C	16A C
Length	Σ lm	Σ lm	Σ lm	Σ luminaires	Σ luminaires	Σ luminaires	Σ luminaires
2.2ft	2600			32	50	52	85
2.2ft	3200	4400		10	16	16	26
2.4ft	5200	6400	8800	10	16	16	26
2.4ft	12800			11	18	18	30
2.5ft	6500	8000	11000	10	16	16	26
2.5ft	16000			11	18	18	30

Huolto- ja kierrätysohjeet

Underhålls- och återvinningsinstruktioner

Hooldus- ja utiliseerimisjuhend

Maintenance and recycling instructions

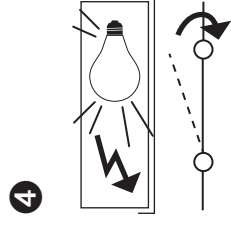
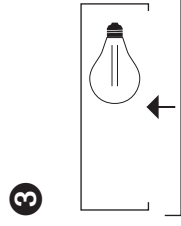
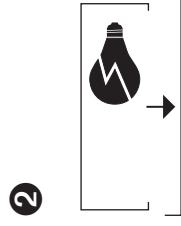
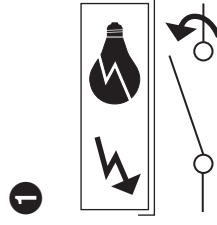
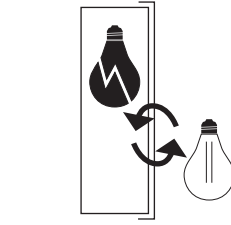
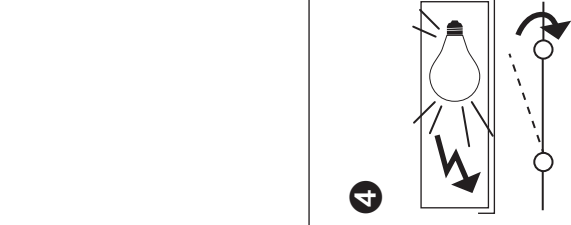
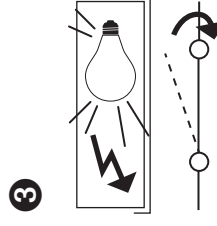
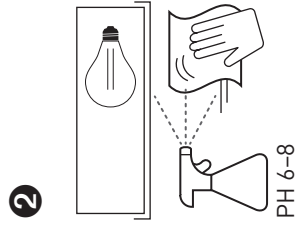
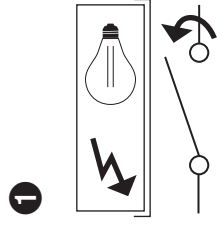
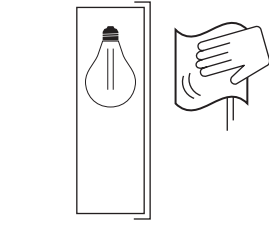
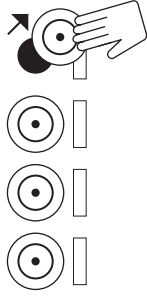
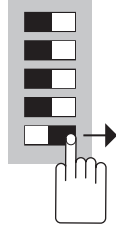
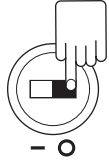
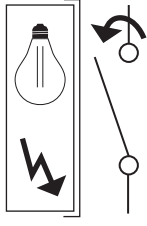

4

Odota, että valaisin on
jäähdytynyt.
Väntä tälls lampen har svalnat.
Oodake, kuni valgusti on
jähtunud.
Wait until the luminaire has
cooled down.

3

2

1

3

2

1

