

# Powerdot

□ 935-PD16W

■ 935-PD16



## CONTENT:

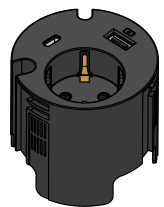

x1



x1



x1

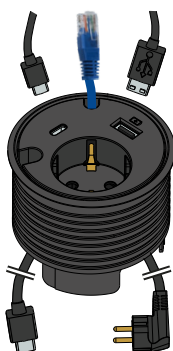

- 1 USB Charger  
QC2.0 (Type-A)

- 1 Schuko socket  
/w 1500 mm cable

- 1 USB Port  
(Type-C Female)  
/w 450 mm cable

- 2 feed-throughs  
(Ø7, Ø9.5 mm)

### 1 DRILL



### 2 INSERT

Insert grommet into the hole, then feed the plug all the way through the threaded fastening nut.

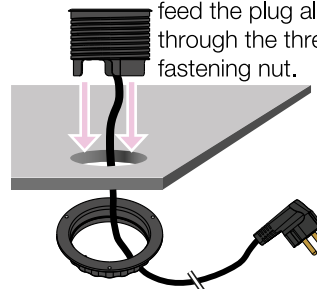

### 3

TURN CLOCKWISE & PLUG IN

Turn the fastening nut as far up the thread as possible. Make sure that it has been thoroughly tightened. Plug the Schuko plug into a wall socket or powerstrip of your choice. Lastly, connect the USB-C cable to intended device.

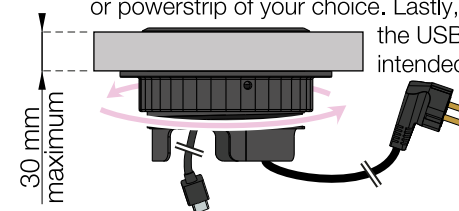

**Note!** The fastening nut has 3 holes for fixing with wood screws.

### A

ADJUSTING HEIGHT

Connect plug to Powerdot to begin releasing the inner part of the grommet.

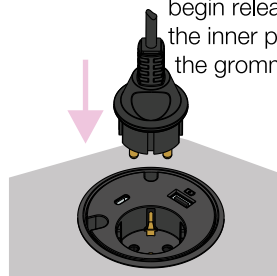

### B

RELEASE INNER PART

Rotate plug counter-clockwise to release the inner part.

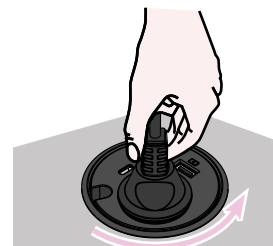

### C

ADJUSTING HEIGHT

The inner part should now be loose. Adjust to desired level - see box: ADJUST LEVELS

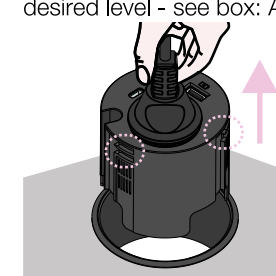

**Note!** Pay attention to the locking geometry as it will help with adjusting the inner part to the desired level.



### !

ADJUST LEVELS

Level 2 must be used when combined with the decorative accessories.

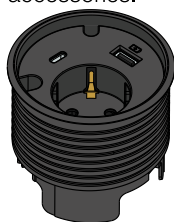

LEVEL 1  
0 mm / Flat

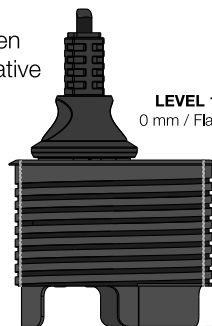

LEVEL 2  
-6 mm / Sunk

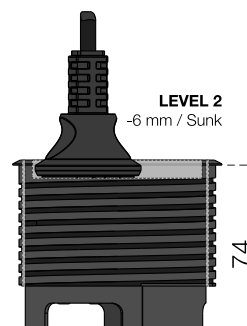

### D

LOCKING POSITION

Rotate clockwise.

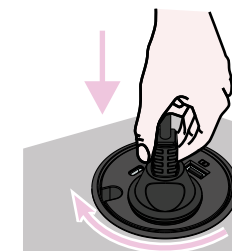

### E

LOCKING POSITION

Rotate clockwise.

