

# Duct

Montering i kabelkanal  
Trunking System Installation  
Asennus johtokanavaan

 Installationsanvisning

 Installation Instructions

 Asennusohje

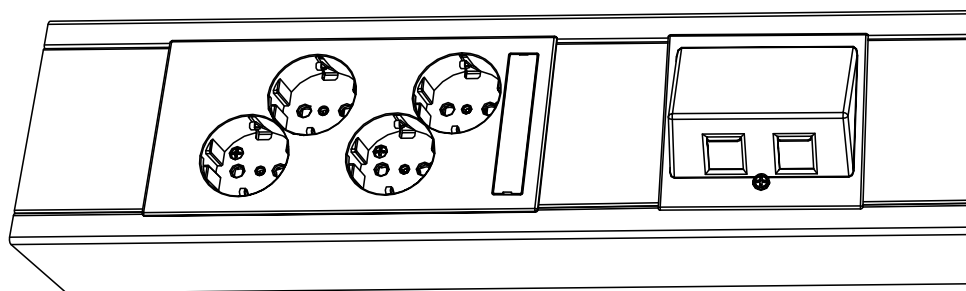

1

Montering  
Assembly  
Kokoonpano

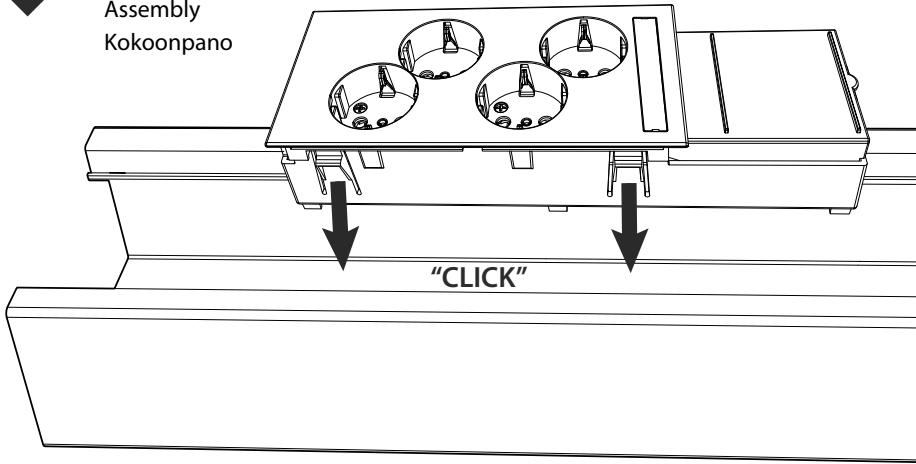

2.1

Kombinera två uttagsboxmoduler  
Combine two socket box modules  
Kahden pistorasiomodulin yhdistäminen

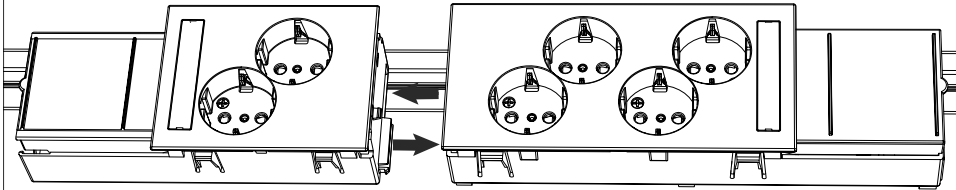

2.2

Montera kombinationen  
Assemble the combination  
Asenna yhdistelmä

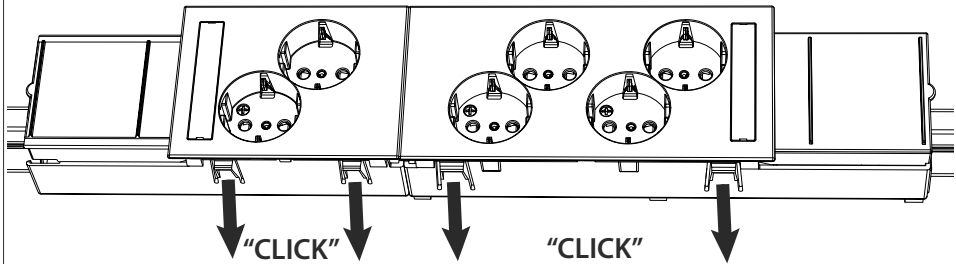

**3.1**

Anslutning / Connection / KytKentä

Duct-2-1	Duct-2D-1
Duct-2-3	Duct-2D-3
Duct-4-1	Duct-4D-1
Duct-4-3	Duct-4D-3

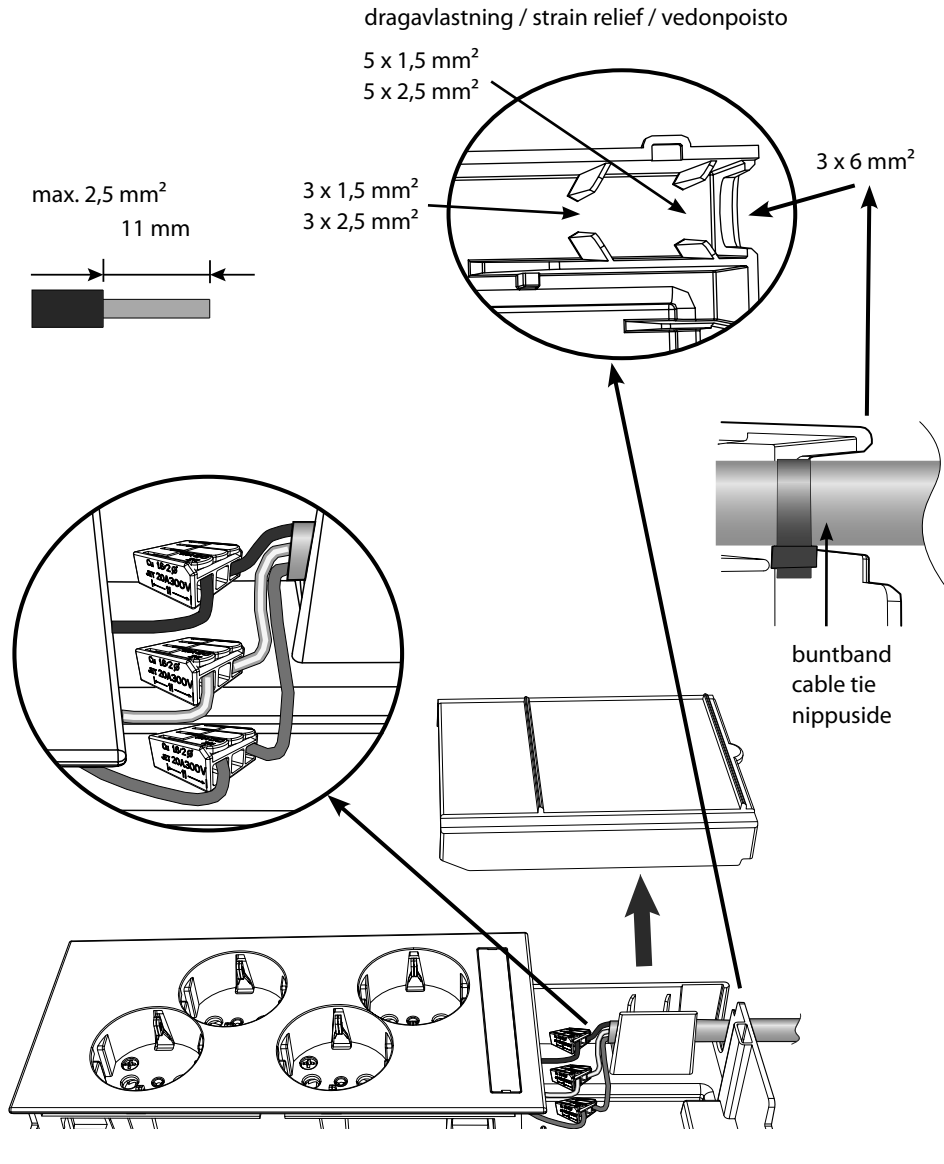

3.2

Kabelingång  
Cable entry  
Kaapelin sisäänmeno

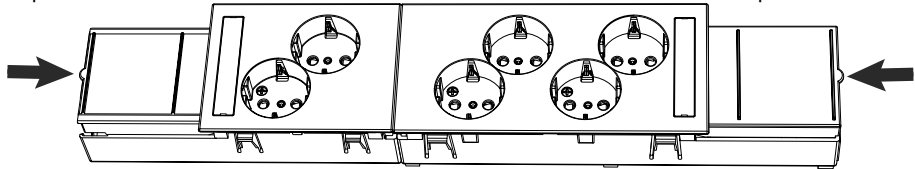

Kabelingång  
Cable entry  
Kaapelin sisäänmeno

4

Alternativ anslutning / Optional Connection / Vaihtoehtoinen kytkentä

Duct-2-1

Duct-2-3

Duct-4-1

Duct-4-3

AL2



6 mm<sup>2</sup>



5

Anslutning / Connection / KytKentä

Duct-2E-1

Duct-2E-3

Duct-4E-1

Duct-4E-3

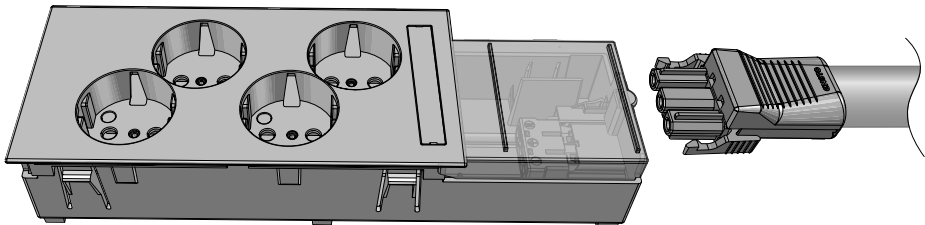

6

Demontering  
Disassemble  
Asennuksen purkaminen

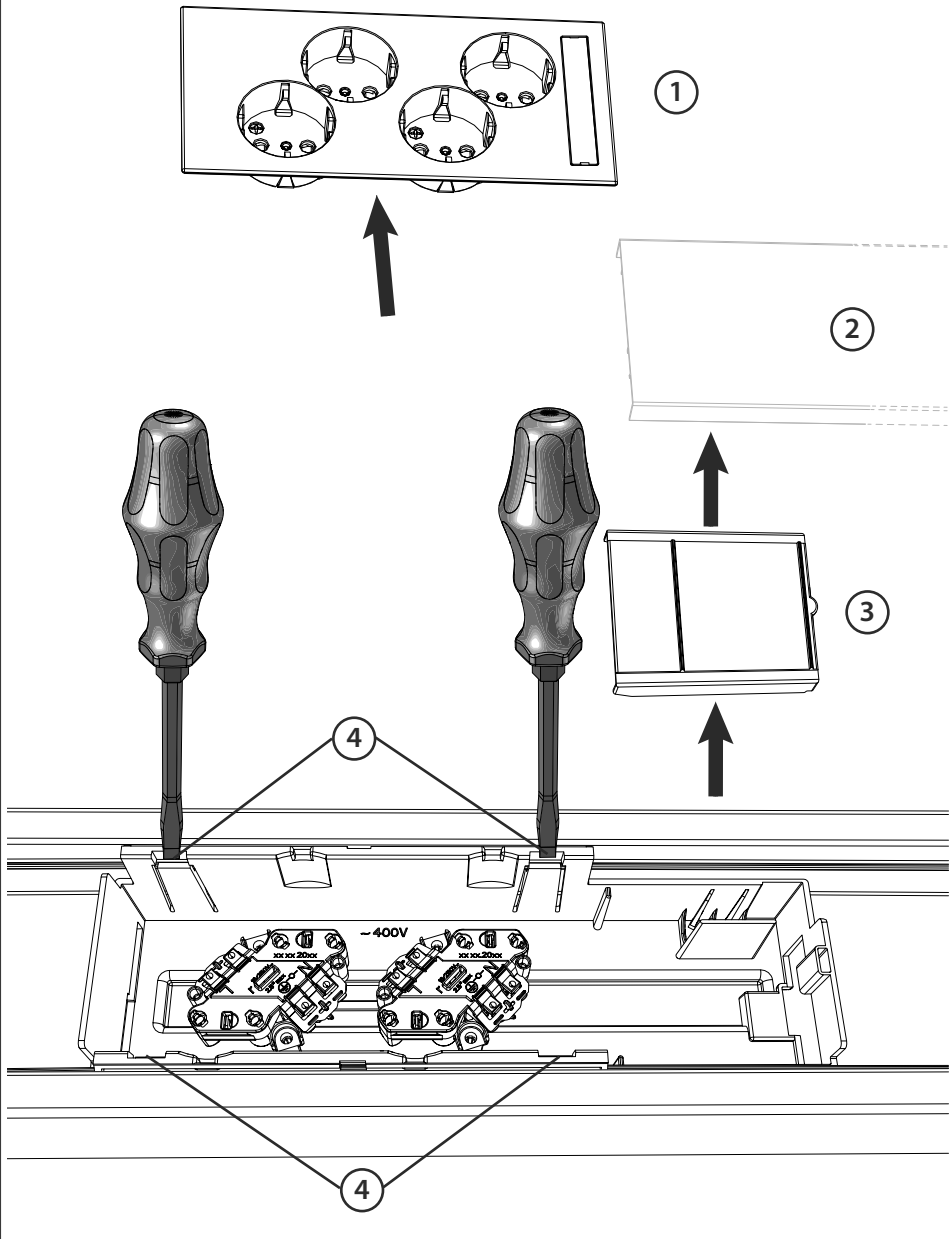

7

Data-anslutning  
Data connection  
Dataliitäntä

